

**Bunkhouse Application Worksheet**

Fill in blanks and check all boxes that apply

Example - Roof Construction:  
Shingles  
7/8" OSB w/ H-Clips  
Trusses @24" o.c.  
T&G pine ceiling

Roof Construction

R\_\_\_\_\_ Insulation  
6mil-CGSB Poly

Example—Wall Construction:

Vinyl Siding  
Housewrap  
3/8" OSB  
2x4 @ 16" o.c.  
T&G pine

Wall Construction

R\_\_\_\_\_ Insulation  
6mil-CGSB Poly

5/8 GWB (fire resistance)  
Req'd @ 48" or less to  
property line

Example - Floor Construction:

3/4" T&G Plywood  
2x6 @ 16" o.c  
PT 6x6 skids @ 48" o.c.  
Compacted granular

Floor Construction

R\_\_\_\_\_ Insulation  
6mil-CGSB Poly

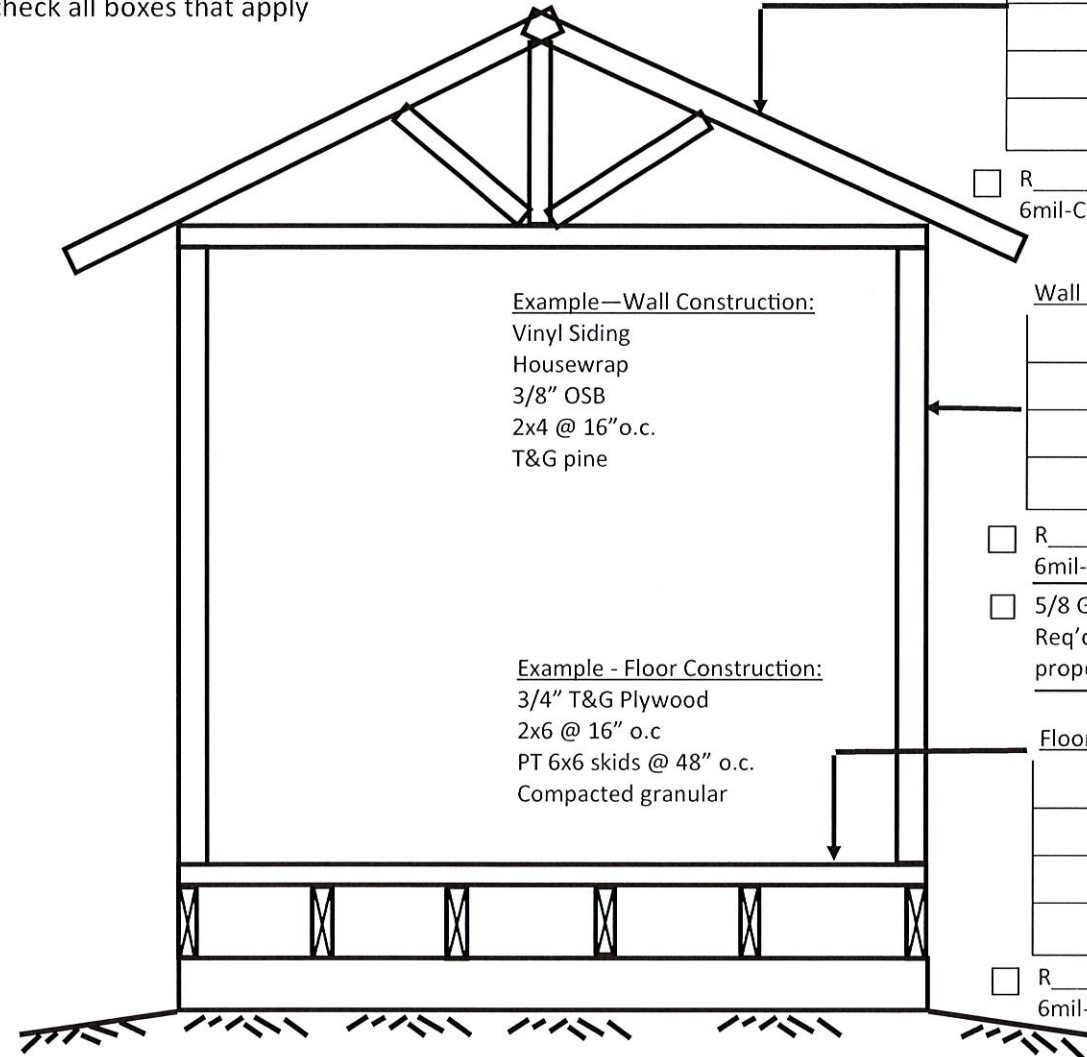

Heating Options:

No Heat     Electric     Other: \_\_\_\_\_

Smoke Alarms:

(req'd in BH, in each bedroom if multiple sleeping rooms)

Battery Op (no power)     Elec Op (bldg. has power)     Where applicable, multiple smoke alarms interconnected

Other Information Attached:

- Floor Plan Sketch: show layout of the bunkhouse including door and window locations
- If more than 1 bedroom, each bedroom without a door must have egress window that allows for an opening with minimum 3.77 ft<sup>2</sup> unobstructed opening, opening must have no dimensions less than 15".
  - If less than 48" to property line, no windows permitted in the wall facing property line, and 5/8" Type X GWB required for fire protection on that wall.
- Site Plan Sketch: show building location and other buildings on property with dimensions to prop lines shown